

Typical Left Turn Lane Construction

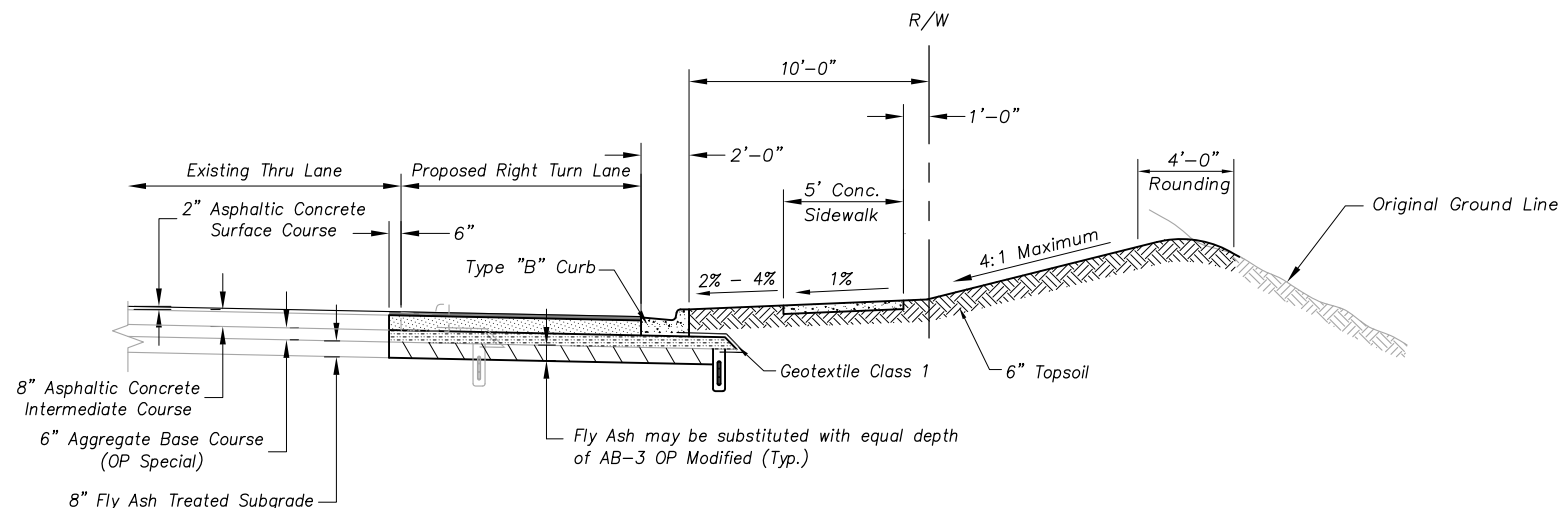

Typical Right Turn Lane Construction

ASPHALT THOROUGHFARE WIDENING

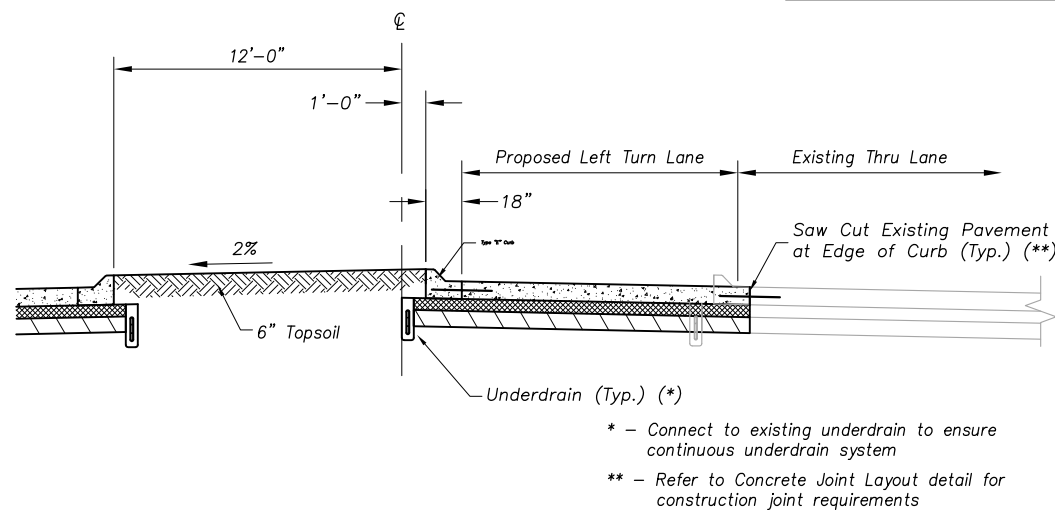

Typical Left Turn Lane Construction

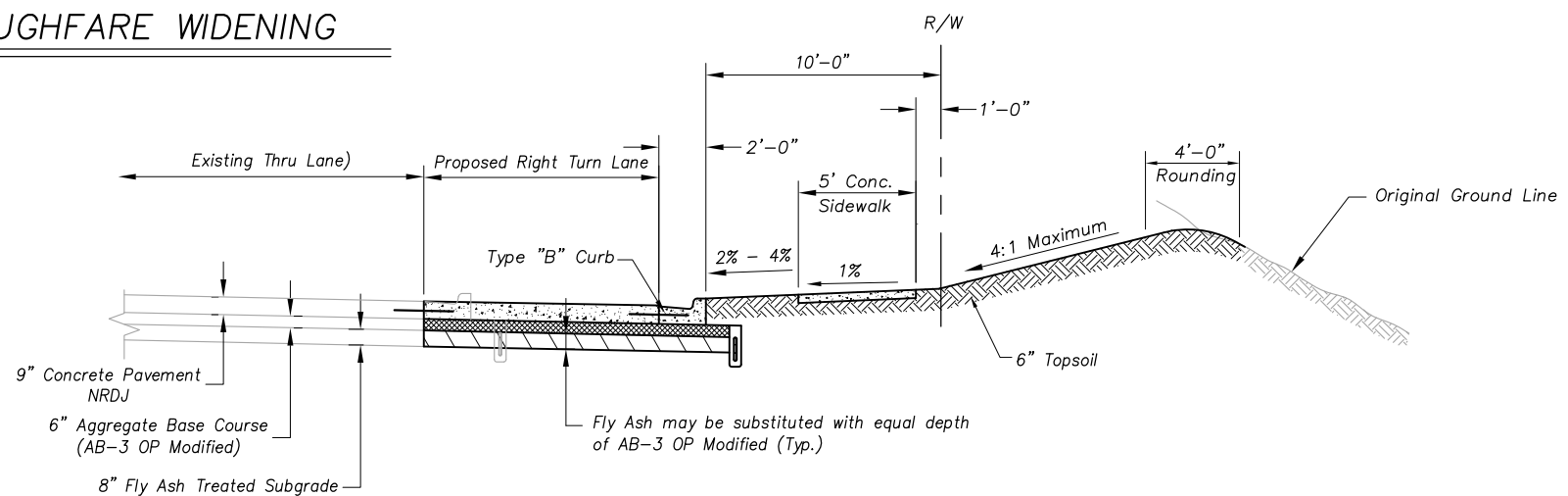

Typical Right Turn Lane Construction

CONCRETE THOROUGHFARE WIDENING

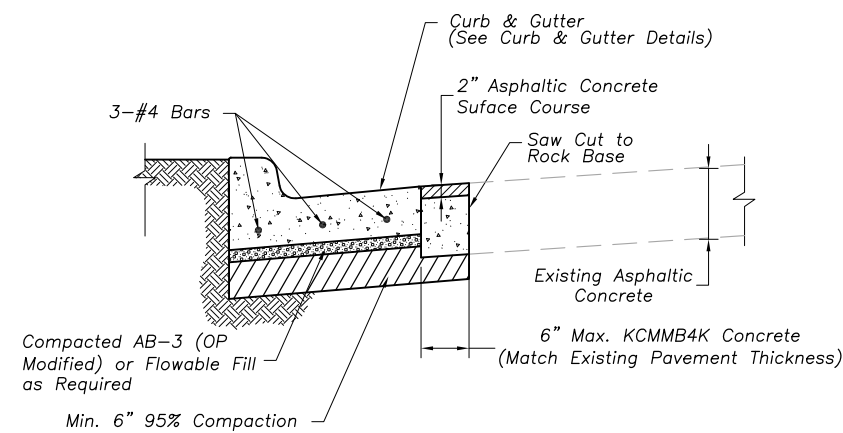

Asphalt Roadway

Curb Replacement Notes:

1. Overland Park Municipal Code (OPMC) and Overland Park Design and Construction Standards Manual (OPDCSM) are incorporated, except as otherwise noted.
2. 1/2" premolded expansion joints shall be placed at points of curvature, curb returns, curb inlets, and at 250' centers. The expansion joints, except @ curb returns and curb inlets, shall be sealed in accordance with OPDCSM. Contraction joints shall be 2" deep, and placed at 15' intervals equally spaced between expansion joints.
3. Concrete used in this work shall be KCMMB4K and shall meet the requirements of the OPMC.

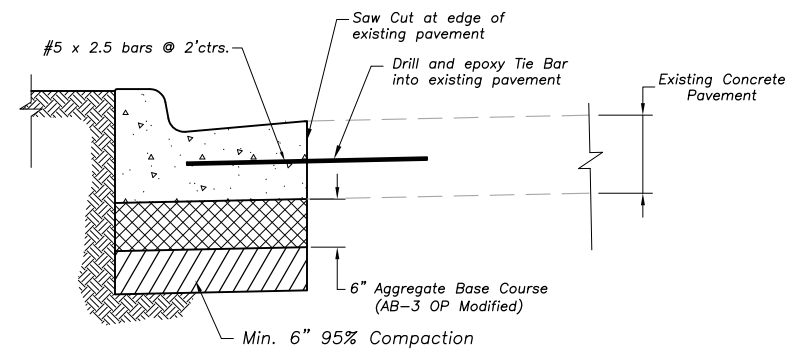

Concrete Roadway

Curb Replacement Notes:

1. Overland Park Municipal Code (OPMC) and Overland Park Design and Construction Standards Manual (OPDCSM) are incorporated, except as otherwise noted.
2. Curb joints shall match existing pavement joints.
3. Concrete used in this work shall be KCMMB4K and shall meet the requirements of the OPMC.

CURB REPLACEMENT

REVISIONS:	
05/20/03	Notes
07/01/03	Concrete Mix Designation
Jan. 2006	Miscellaneous
Feb. 2008	OPMC Reference
RELATED ORDINANCES:	
OPMC Title 13	



DEPARTMENT OF PUBLIC WORKS
 STANDARD DETAILS
 THOROUGHFARE WIDENING
 AND CURB REPLACEMENT DETAILS

Year 2018 Edition